

The future in tables
for the restaurant industry.

TECHNOLOGY MEETS DESIGN

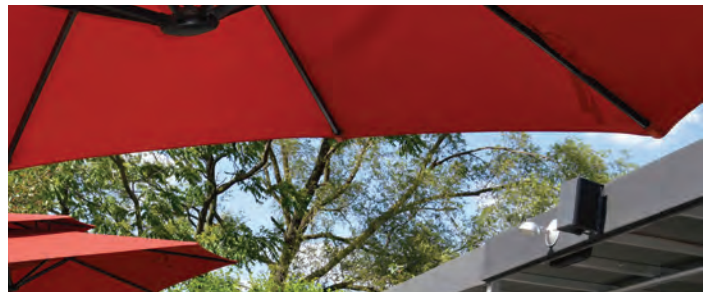

**PREMIUM WOOD POWDERCOATED TABLES
WITH A FLAWLESS FINISH**



**A SUBSTANTIAL COST EFFECTIVE ALTERNATIVE
FOR INDOORS & OUTDOORS TO SOLID SURFACE,
SOLID WOOD AND EDGE BAND TABLES**

2017

Perfect Tables
with Abcor finish technology

PERFECTTABLES.NET

PREMIUM MDF WOOD CORE TABLES

Our powdercoated product has been used widely in the office furniture, health care, retail and cabinet industries to name a few. Now the same durability and seamless finish is being offered to the restaurant industry.

- TRUSTED FOR 15+ YEARS - NOW AVAILABLE TO THE RESTAURANT INDUSTRY
- SEAMLESS ABCOR FINISH TECHNOLOGY
- UNSURPASSED DURABILITY & EXCEPTIONAL IMPACT RESISTANCE
- ANTI-MICROBIAL POWDERCOAT AVAILABLE
- 10 YEAR STRUCTURAL WARRANTY
- COST EFFICIENT
- ECO-FRIENDLY
- ACRYLIC TOP COAT AVAILABLE



See our website for additional sample photos and contact us to request a table sample.



CUSTOM COORDINATING BAR
& COUNTER TOPS AVAILABLE

Perfect Tables
with Abcor finish technology
PERFECTTABLES.NET

EDGE & CORNER OPTIONS

EDGES

FULL BULLNOSE

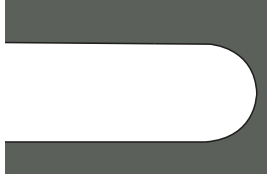

HALF BULLNOSE



INLAID BULLNOSE

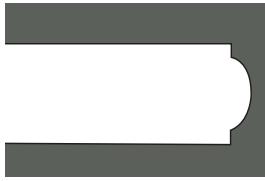

EASED SQUARE



SQUARE



1/4 BEVEL

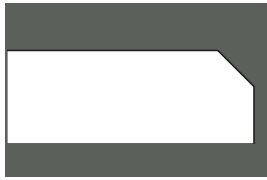

DOUBLE BEVEL



OGEE EDGE

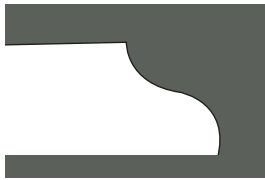

INLAID OGEE EDGE

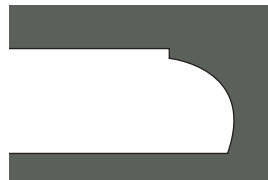

REVERSE KNIFE

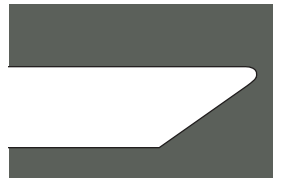

CORNERS

SQUARE

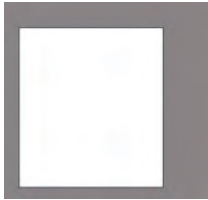

1" RADIUS



2" RADIUS



OUR FLEXEDGE

CAN WITHSTAND IT ALL

FlexEdge molded edge is injected into the table creating a continuous table top option with extra padding. FlexEdge is a favorite in fast food applications.



Available in several color options.

STANDARD THICKNESS: 1 1/8" DROP EDGE THICKNESS: UP TO 2 1/4"

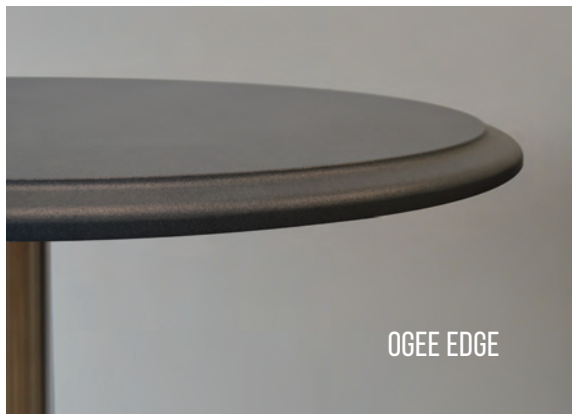

OGEE EDGE



FULL BULLNOSE

Tables are available in standard and custom shapes and sizes.

OUTDOOR

Our outdoor treated wood tables feature a high bond integrity - 2X as much as the standard MDF substrate. This distinctive table type enhanced with resin composites offers extreme moisture and liquid resistance for all types of weather and superior durability.

Perfect Tables
with Abcor finish technology

PERFECTTABLES.NET

351 Ridgepoint Drive Carmel, IN 46032
(317) 564-8173 info@perfecttables.net

FINISHES

STANDARD COLORS

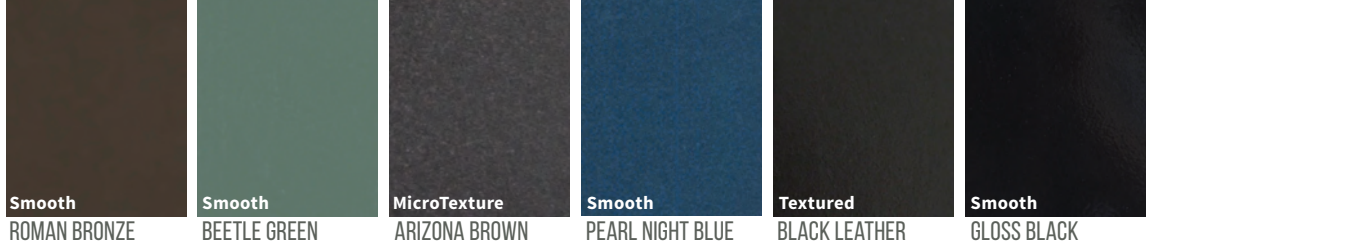
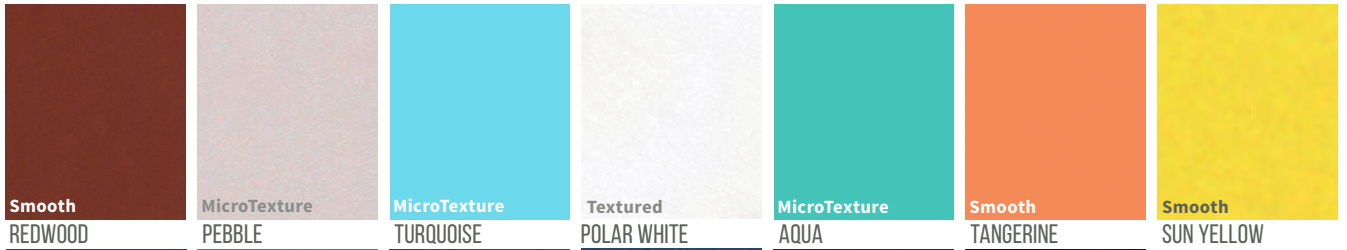

STONE

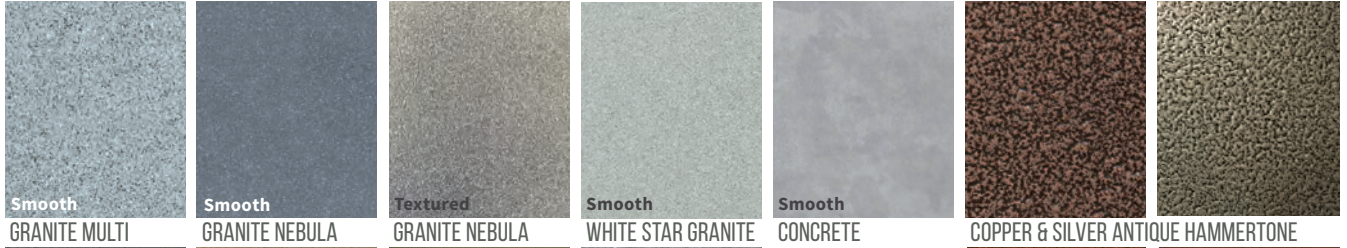

METALLIC



WOOD GRAIN



COMING SOON



Custom colors are also available.

Check the website for the latest color selection.



Dye Sublimation



Etching

INCLUDE YOUR LOGO OR DESIGN ON ANY TABLETOP THROUGH ETCHING OR THE DYE SUBLIMATION PROCESS



NO EDGE BANDING:

**SEAMLESS POWDERCOAT TECHNOLOGY ALLOWS FOR
A CONSISTENT FINISH ON ANY EDGE STYLE & TABLE SHAPE**

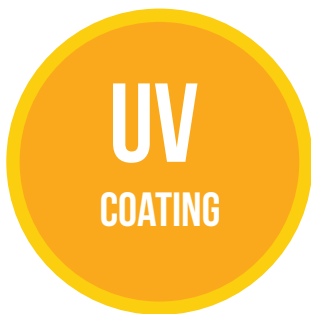

FADE RESISTANT

UV coating protects against fading from sun exposure.



NO RINGS LEFT BEHIND

Cold and hot beverages won't leave a ring behind with powdercoated finish.



STAIN AND HEAT RESISTANT

Our Abcor powdercoating technology resists stains, and is hot dish tolerant.

Perfect Tables
with Abcor finish technology

PERFECTTABLES.NET



Powdercoating facility in Holland, Michigan.



NEAR-ZERO WASTE PLANT

Our MDF Powdercoating plant is a near-zero waste facility.

**UNPRECEDENTED
STRUCTURAL
WARRANTY
10 YEAR INDOOR
2 YEAR OUTDOOR**

F.A.Q.

1

WHY IS POWDERCOATING BETTER THAN LAMINATE?

Traditional tables combine laminate with wood or plastic. The powdercoating process coats all sides and every angle of the table top - providing a durable and impermeable surface free of seams, delamination and shape constraints.

2

WHAT MAKES POWDERCOATED TABLE TOPS AFFORDABLE?

Unlike wood edge, solid surface and solid table tops - the process for our powdercoated quality MDF table tops has fewer steps and is completed in one facility.

3

IS POWDERCOATING WOOD DIFFERENT FROM METAL?

Abcor Industries has perfected the wood powdercoating process through extensive research and development. It differs from metal through a combination of heat transfer, powder formulation, powder application and the curing process to achieve a finish to our quality MDF.

4

ARE THE TABLES MADE IN THE USA?

Yes, 100% of the parts and the manufacturing process for our tables is completed within the USA.

5

HOW DO THE TABLES REACT TO VANDALISM?

The outdoor core repels water and is non-absorbing, preventing any damage to the table core from cuts and scrapes from knives and sharp objects. A special matching liquid compound with a brush applicator should be applied to the damaged area. The standard MDF table core should not be compromised if touched up in a timely manner. The Hammertone and textured finishes or the optional Acrylic Clear Coat will minimize any intentional cuts through the powder coated surface.



With over 20 years of experience in the restaurant industry our staff is equipped with the expertise to help you find the perfect table and finish.

Perfect Tables
with Abcor finish technology

PERFECTTABLES.NET

*Standard lead time is 4 weeks, add 1-2 weeks for wood grain and marble finishes. Quick ship models are available.

351 Ridgepoint Drive Carmel, IN 46032
(317) 564-8173 info@perfecttables.net